

SOAPWORKS



A BUILDING LIKE NO OTHER.

CURATED, COMMUNITY-FOCUSED SPACE.

Be part of the Soapworks Scheme to gain access to a range of community activities, events and fundraisers.

With an on-site estates team keeping Soapworks at the forefront of Space as a Service, no two weeks are the same.



**UNMISSABLE
EXPERIENCES.**



**ENRICHING
TEAMS.**



**SEASONAL
EVENTS.**

**COMMUNITY
SCHEMES.**



DOING GOOD.



CONNECTED.

Promoting climate-friendly travel with exceptional transport links, secure bike storage, electric bikes/scooters for hire at the front gate and quality shower facilities.

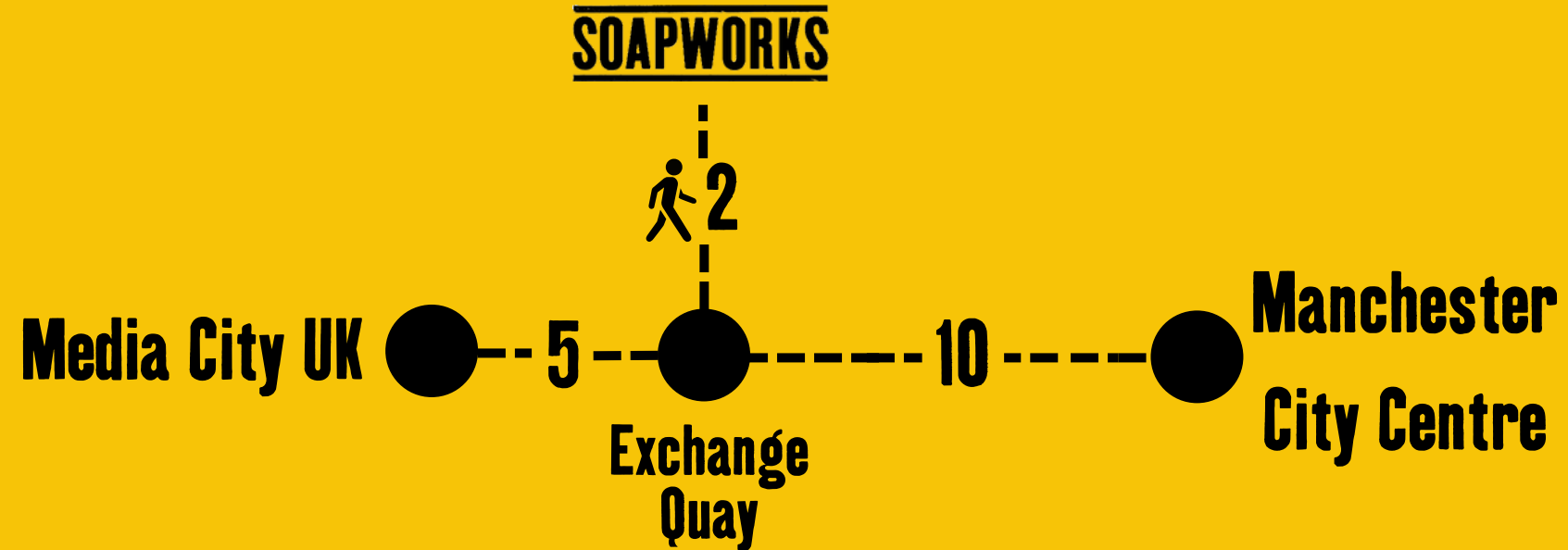

CITY CENTRE 10
TRAIN STATION 10



CITY CENTRE 10
TRAIN STATION 15



CITY CENTRE 5
AIRPORT 15
M60/M62 5

**On-site hireable
EV Chargers**

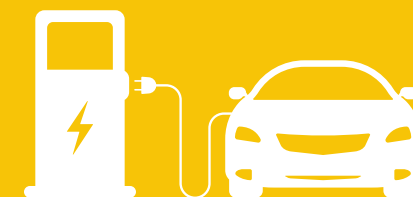

SOAPWORKS



BICYCLE PARK

MORE THAN A BUILDING.

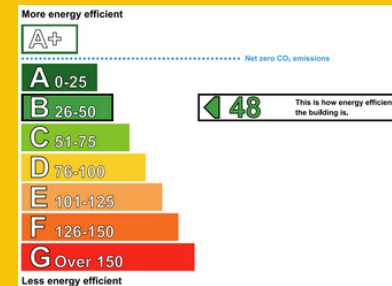

ENVIRONMENTAL

EPC B ●

BREEAM EXCELLENT ●

PRO-ACTIVE ENERGY MONITORING SCHEME ●

SOLAR ENERGY EQ. TO 87 HOUSES COMING Q4 '23 ●

COMMUNITY

LOCAL FOOTBALL TEAM SPONSORSHIP ●

PROMOTING LOCAL BUSINESSES ●

SEASONAL DONATION DRIVES ●

DONATE 1000+ ITEMS OF AID EVERY YEAR ●



SUITE B1- GF

5593 sq ft.
55 PERSON OFFICE

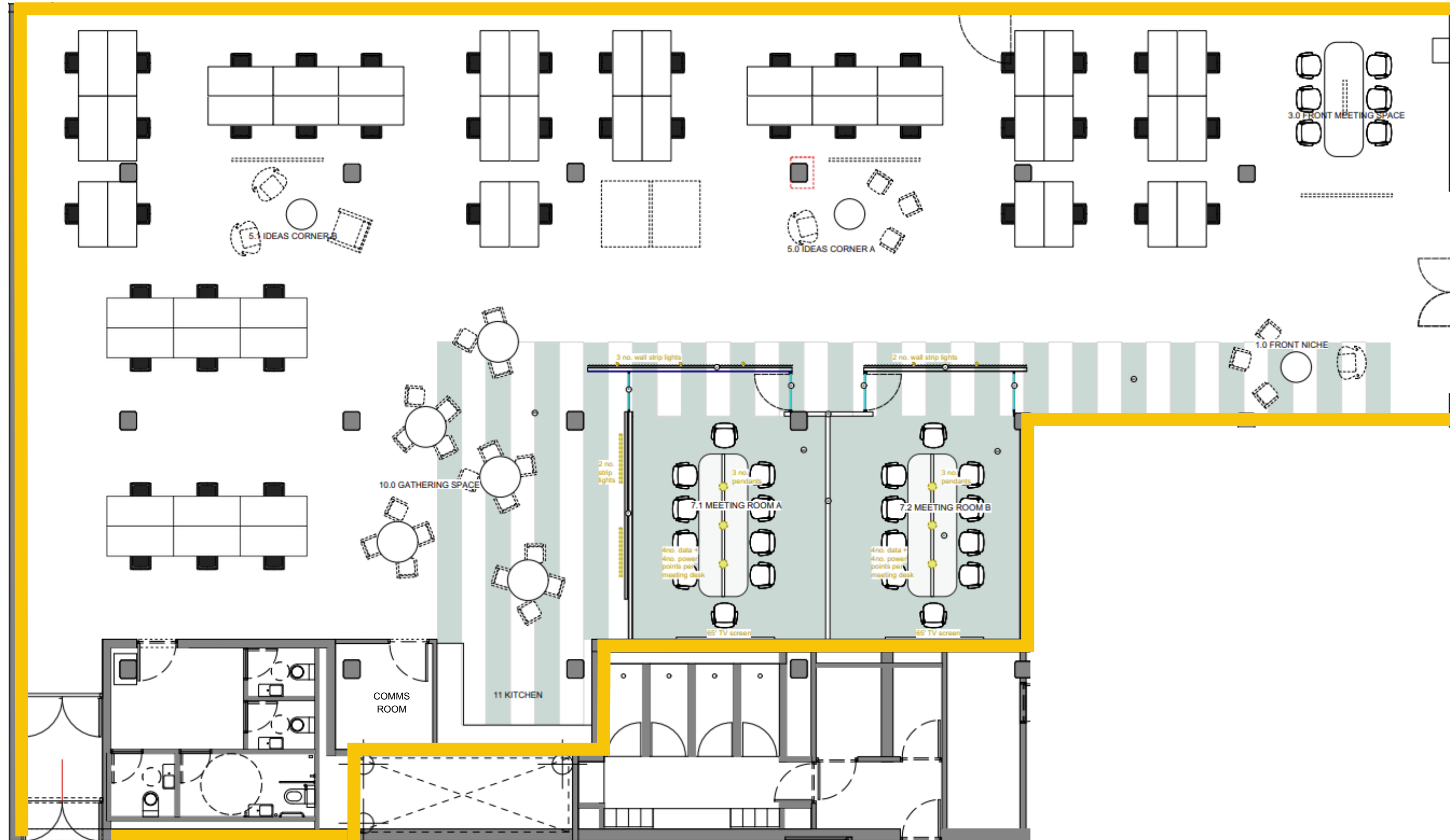

Fit-out

- >> LG3 Lighting
- >> Demised VRF System
- >> Raised Access Floor
- >> 1:10
- >> Demised Toilets

Potential Layout

- >> Suitable for 55 desks
- >> 2 x 10-Person Meeting Rooms
- >> 5 x Flexible Breakout Areas
- >> 4 x Demised Toilets
- >> Kitchen Area

